

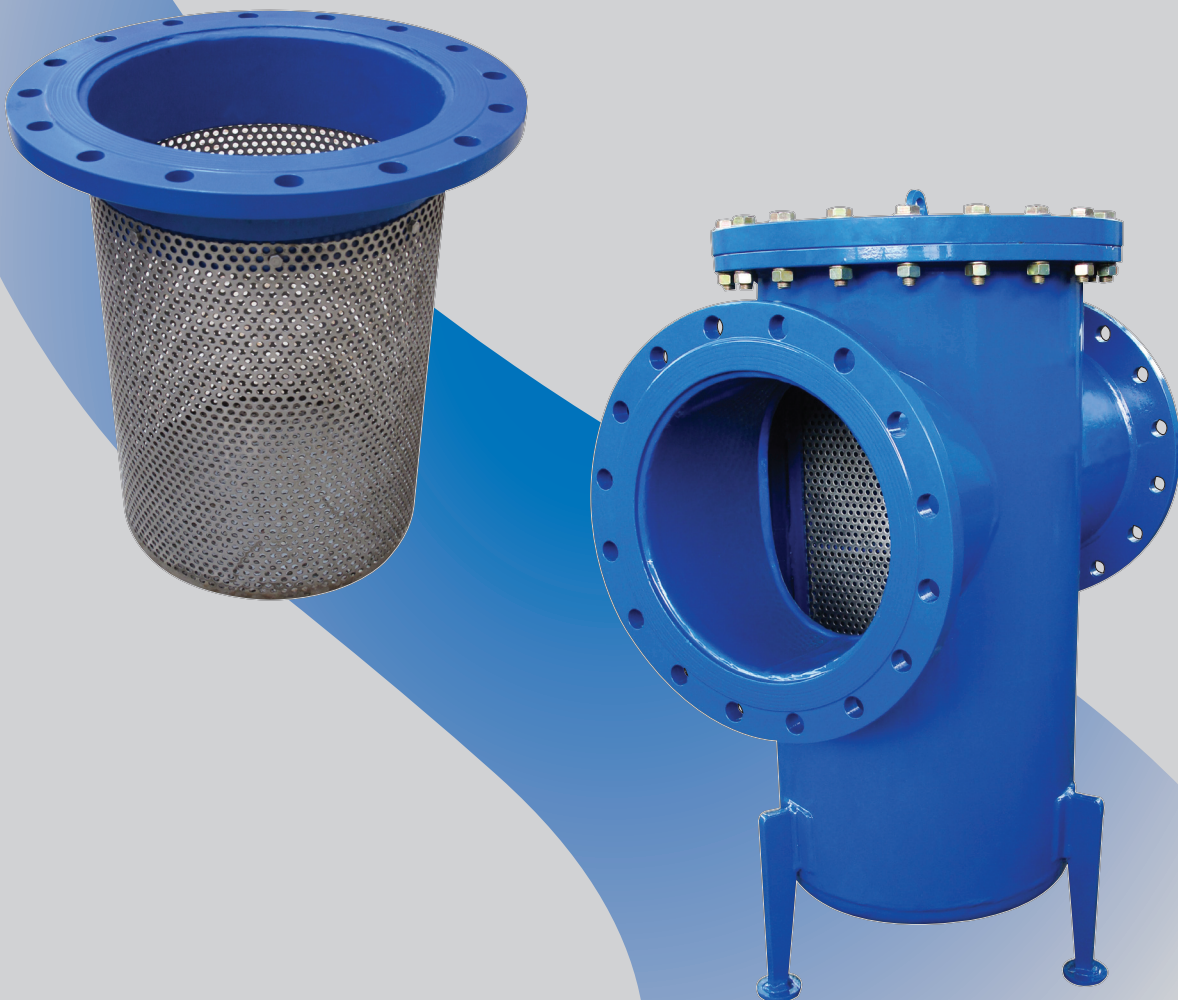

**NeroValves GmbH**

**Strainers**



## Strainer T-Type with flat screen – Type St2

Flange Drilling as per ISO 7005-1( EN 1092 – 1, DIN 2501) Standard

### Features:

Exchangeable screen made of corrosion and acid resistant steel, with deaeration screw on the cover and discharge screw in the floor.

### Options:

- Screen material and mesh size as per request.
- Strainer can be delivered without flanges
- Flanges according to ANSI standard.

### Coating:

All parts are coated with electrostatic epoxy powder with minimum 250 micron suitable for potable water.

### Material Specification:

Body	Steel/Ductile Iron
Flange	Steel/Ductile Iron
Seal	EPDM or NBR
Screen	Stainless Steel 304 or 316
Bolts & Nuts	Galvanized / Stainless Steel

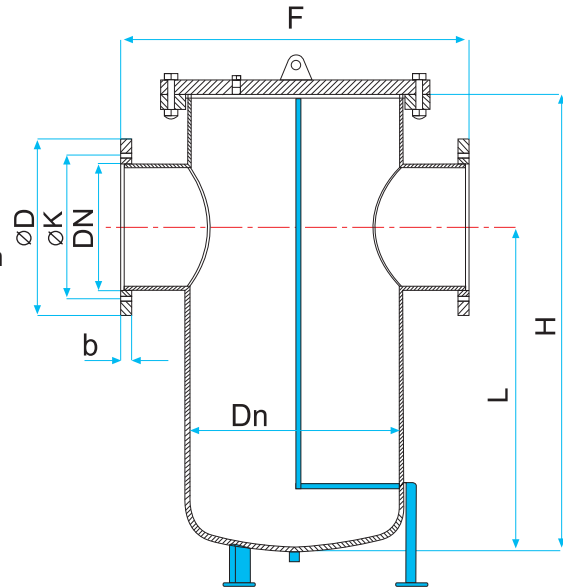

DN	Dn	F	L	D			K		
				PN10	PN16	PN25	PN10	PN16	PN25
150	250	400	425	285	285	300	240	240	250
200	300	500	467	340	340	360	295	295	310
250	350	600	500	395	405	425	350	355	370
300	400	700	533	445	460	485	400	410	430
350	450	800	633	505	520	555	460	470	490
400	500	900	700	565	580	620	515	525	550
450	550	1000	733	615	640	670	565	585	600
500	600	1100	800	670	715	730	620	650	660
600	700	1300	933	780	840	845	725	770	770
700	800	1500	1067	895	910	960	840	840	875
800	1000	1700	1200	1015	1025	1085	950	950	990
900	1100	1900	1300	1115	1125	1185	1050	1050	1090
1000	1200	2100	1467	1230	1255	1320	1160	1170	1210
1200	1400	2200	1567	1455	1485	1530	1380	1390	1420

Specification for larger sizes and pressure more than 25 bars will be provided as per request.

## Strainer T-Type with cylindrical screen – Type St3

Flange Drilling as per ISO 7005-1( EN 1092 – 1, DIN 2501) Standard

### Features:

Exchangeable screen made of corrosion and acid resistant steel, with deaeration screw on the cover and discharge screw in the floor.

### Options:

- Screen material and mesh size as per request.
- Strainer can be delivered without flanges
- Flanges according to ANSI standard.

### Coating:

All parts are coated with electrostatic epoxy powder with minimum 250 micron suitable for potable water.

### Material Specification:

Body	Steel/Ductile Iron
Flange	Steel/Ductile Iron
Seal	EPDM or NBR
Screen	Stainless Steel 304 or 316
Bolts & Nuts	Galvanized / Stainless Steel

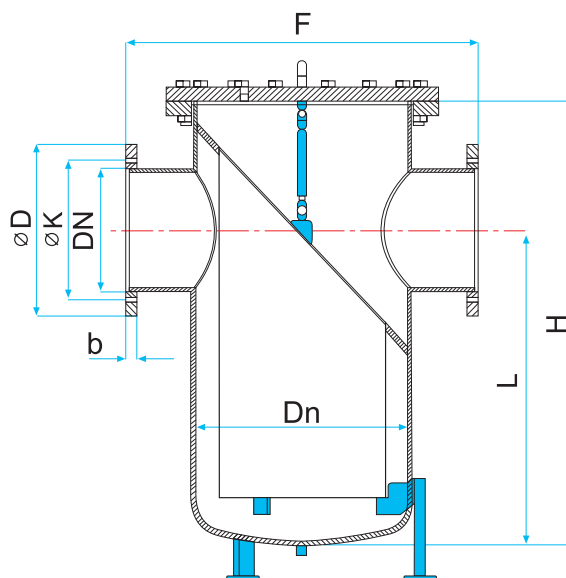

No.	DN	Dn	F	H	L	D			K		
						PN10	PN16	PN25	PN10	PN16	PN25
1	200	400	600	750	500	340	340	360	295	295	310
2	250	450	730	850	560	395	405	425	350	355	370
3	300	550	850	1050	700	445	460	485	400	410	430
4	350	600	980	1150	760	505	520	555	460	470	490
5	400	700	1100	1300	860	565	580	620	515	525	550
6	450	750	1200	1400	930	615	640	670	565	585	600
7	500	800	1250	1500	1000	670	715	730	620	650	660
8	600	900	1450	1700	1130	780	840	845	725	770	770
9	700	1000	1650	1900	1260	895	910	960	840	840	875
10	800	1100	1850	2100	1400	1015	1025	1085	950	950	990
11	900	1200	2050	2300	1530	1115	1125	1185	1050	1050	1090
12	1000	1300	2250	2650	1760	1230	1255	1320	1160	1170	1210

Specification for larger sizes and pressure more than 25 bars will be provided as per request.



## Mono Flange Strainer – Type St7

Flange Drilling as per ISO 7005-1( EN 1092 – 1, DIN 2501) Standard

### Usage:

It uses for prevent of entry of foreign particles into the pipe during the water.

### Coating:

All parts are coated with electrostatic epoxy powder with minimum 250 micron suitable for potable water.

### Material Specification:

Body	Steel/Ductile Iron
Flange	Steel/Ductile Iron
Screen	Stainless Steel 304 or 316
Bolts & Nuts	Galvanized / Stainless Steel

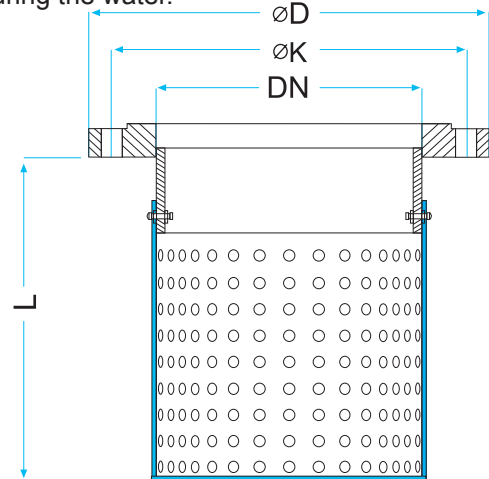

K			D			L	DN	NO
PN25	PN16	PN10	PN25	PN16	PN10			
125	125	125	165	165	165	140	50	1
145	145	145	185	185	185	155	65	2
160	160	160	200	200	200	190	80	3
190	180	180	235	220	220	240	100	4
220	210	210	270	250	250	290	125	5
250	240	240	300	285	285	310	150	6
310	295	295	360	340	340	370	200	7
370	355	350	425	405	395	380	250	8
430	410	400	485	460	445	380	300	9
490	470	460	555	520	505	560	350	10
550	525	515	620	580	565	560	400	11
600	585	565	670	640	615	560	450	12
660	650	620	730	715	670	560	500	13
770	770	725	845	840	780	860	600	14
875	840	840	960	910	895	860	700	15
990	950	950	1085	1025	1015	1080	800	16
1090	1050	1050	1185	1125	1115	1080	900	17
1210	1170	1160	1320	1255	1230	1100	1000	18
1420	1390	1380	1530	1485	1455	1120	1200	19
1640	1590	1590	1755	1685	1675	1400	1400	20

Specification for larger sizes and pressure more than 25 bars will be provided as per request.



**NeroValves GmbH**

**Industrial Valves: DIN - API - ASME**

Nordend Str. 48  
64546 Morfelden-  
walldorf / Germany

Tel: +49-(0) 6105-408 188-0

Fax: +49-(0) 6105-408 188-5

Email: [info@nero-valvesgmbh.de](mailto:info@nero-valvesgmbh.de)

[www.nero-valvesgmbh.de](http://www.nero-valvesgmbh.de);

[www.nero-valves.com](http://www.nero-valves.com)